

EC-II

Proudly built by Elkhart Coach



ec
Elkhart Coach

A DIVISION OF FOREST RIVER

FORD EC-II STANDARDS AND OPTIONS

STANDARD CHASSIS FEATURES

- Ford E-450 & E-350 DRW Cut-Away Chassis
- Electronic 5-Speed Automatic Transmission
- 55 or 40 Gallon Fuel Tank
- Ford V-10 6.8L Gas Engine
- Ford V-8 5.4L Gas Engine
- OEM Installed Dash Air Conditioning & Heat
- 225 or 155 Amp Alternator
- 138", 158", 176", 186" or 190" Wheelbases
- Heavy Duty Engine Cooling Package
- Chrome Front Bumper & Grill
- 14,500, 12,500 & 11,500 GVWR
- Dual Electric Horns
- Driver Air Bag
- Heavy Duty Suspension
- Power Steering/Brakes
- LT225 / 75RX16E Tires
- Dual 650 CCA Batteries
- Tilt Steering Wheel/Cruise Control
- Dual Beam Headlights

STANDARD BODY FEATURES

- FMVSS Certified
- STURAA Tested for 7 Years/200,000 Miles
- Insulated Roof & Exterior Walls
- Mor-View Right Side Cab Window
- Smooth Rubber Floor w/ Ribbed-Rubber Aisles
- Rear ABS Fender Flares
- Powder Coated Rear Steel Bumper

- Rear Mud Flaps
- Entrance Door & Driver Modesty Panels
- All Aluminum Sidewalls and Skirts
- Dual Drive Shaft Guards
- Entry Door Assist Handles
- Fully Welded Unitized Steel Cage Body Structure
- Undercoating
- Swing-A-Way Exterior Flat Mirrors with Integrated Convex Panels
- Drip Rail Over Passenger Windows & Entry Doors
- White or Yellow Step Nosing – All Entry Steps
- Color/Function Coded Wiring Harness
- Laminated Steel Reinforced Composite Construction
- Master Electronic Printed Circuit Control Panel
- Emergency Side Egress Windows
- Stylized ABS Rear Trim
- 91" Interior Width & 77" Headroom
- Large 36" x 36" & 24" x 36" Upper T-Slider Windows
- 22" x 64" Rear Egress Window
- Single Piece Seamless FRP Roof
- Smooth FRP Interior Walls
- FRP Ceiling

POPULAR OPTIONS

- Rear Heat System
- Front and Side Destination Signs
- Mor/Ryde Suspension
- Individual Reading Lights
- Spare Tire & Wheel
- Interior Luggage Rack
- Interior Convex Mirror
- Back-Up Alarm
- Overhead Luggage Racks
- Exterior Rear Center Mount Brake Light
- Rear Luggage Compartment
- Ceiling Grab Rails
- AM/FM Radio w/ CD Player
- "Flat Floor" (No Wheel Well Risers)
- DVD Player w/ Flip Down Monitor
- Heated/Remote Exterior Mirrors
- High-Back or Mid-High Seats with Armrests
- Front Mud Flaps
- Ground Plane For Two-Way Radio Installation
- Paging System
- Rear Emergency Door with Ajar Package
- LED Interior & Exterior Lighting
- Rear A/C System
- Roof Escape Hatch
- Stainless Steel Wheel Inserts
- ADA Mobility Compliance Package
- All FRP Exterior
- Driver Running Board
- Electric Entry Door

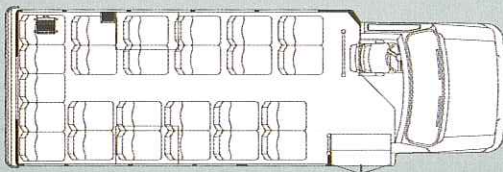

25 Passenger - Forward Facing Seating

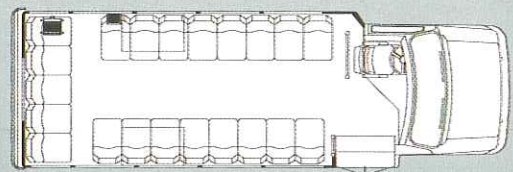

21 Passenger Perimeter Seating

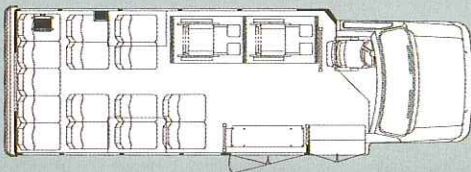

15 Passenger - 2 Wheelchairs - Front Lift

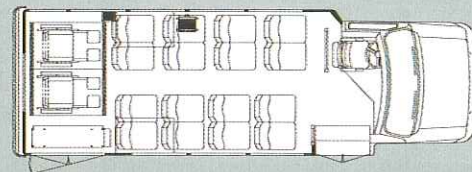

16 Passenger - 2 Wheelchairs - Rear Lift



YOUR DEALER

Forest River, Inc. 55470 C.R. 1 Elkhart, IN 46515-3030
574.389.4600 www.forestriverinc.com www.forestriveraccessories.com

Due to constant product improvements, specifications, component parts and optional equipment are subject to change without notice or obligation. See your dealer for details.